

PCB LAYOUT

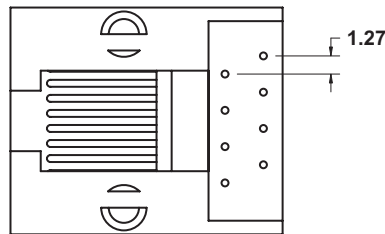

NOTE:

Electrical Char.

Insulation Resistance: 500M Ω Min.
 Contact Resistance: 20m Ω Max.
 Rated Current: 1.5A Min.
 Dielectric Voltage: 1000 RMS 60 Sec. Min.

Physical Char.

Housing: PBT 20% Glass Filled (UL 94V-0)
 Color: Black
 Contact Wires: 0.45mm Dia. 6 μ gold plated over phosphor bronze nickel plated
 Temperature Range: -25 $^{\circ}$ C ~ 90 $^{\circ}$ C
 Durability: 500 Mating cycles Min.

TITLE		SCALE
PC MOUNT MODULAR JACK		2 : 1
DRAWING NO. 12-288		
		UNITS mm
FILE NAME	12-288.pdf	SHEET 1/1



Mode Electronics Part Number 12-288-0